

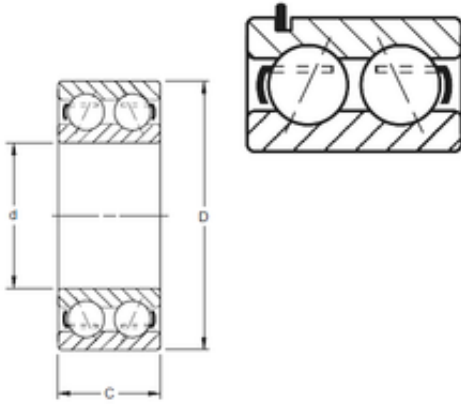

# TIMKEN AXLE CORP.

## TIMKEN 5315KG Angular Contact Ball Bearings

Bearing No. 5315KG



5315KG Bearing 2D drawings and 3D CAD models

Size	75x160x68.3 mm
Bore Diameter	75 mm
Outer Diameter	160 mm
Width	68,3 mm
d	75 mm
D	160 mm
C	68,3 mm
Angle ( )	20 °
Weight	6,428 Kg
Basic dynamic load rating (C)	266 kN