

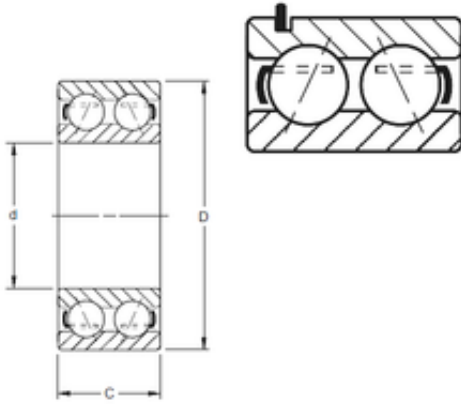

TIMKEN AXLE CORP.

TIMKEN 5305KG Angular Contact Ball Bearings

Bearing No. 5305KG



5305KG Bearing 2D drawings and 3D CAD models

Size	25x62x25.4 mm
Bore Diameter	25 mm
Outer Diameter	62 mm
Width	25,4 mm
d	25 mm
D	62 mm
C	25,4 mm
Angle ()	20 °
Weight	0,376 Kg
Basic dynamic load rating (C)	37,7 kN